

Long term REALTY CAPITAL, LLC
INST. NO. 202000001968
OPRODCT

N. WINNETKA AVENUE
66' ROW (formerly Earl Street
Vol. 90, Pg. 20 DRDCT)

R=1482.69'
D=16°29'33"
L=426.79'
N 54°21'10" E
CD=425.32'

Lot 3A, Block 19/3980
5.815 Ac.
(253,293 S.F.)

25 SURVEY
T NO. 290

Lot 1
MARCO POLO
GOMEZ ADDITION
Vol. 2003156, Pg. 200 DRDCT

Line Table		
Line #	Bearing	Distance
BL1	S 43°08'17" W	56.17'
BL2	S 54°42'43" W	78.70'
BL3	S 89°56'08" E	48.54'
BL4	S 33°57'32" E	68.78'
BL5	N 56°02'28" E	25.00'
BL6	N 33°57'32" W	70.00'
BL7	S 89°56'08" E	54.12'

Scale: 1" = 50' May, 2021 SEI Job No. 21-068

Notary Public, State of Texas

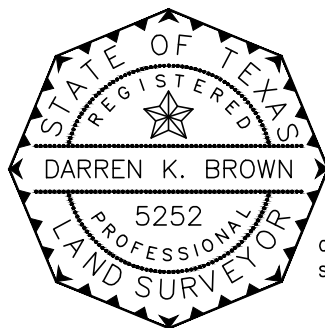

darren.brown@
spiarsengineering.com

LEGEND	
ADS	3-1/4" ALUMINUM DISC STAMPED "LWC ADDITION SPARSING RPLS 5252" SET
BWS	1-1/2" BRASS WASHER STAMPED "DFP ADDITION SPARSING RPLS 5252" SET
IRF	WITH A PK NAIL
CM	IRON ROD FOUND
CM	CONTROL MONUMENT
Emst.	EASEMENT
UTL.	UTILITY
(BTIP)	BY THIS PLAT
R.O.W.	RIGHT-OF- WAY
BL	BUILDING LINE
Vol.	VOLUME
Pg.	PAGE
No.	NUMBER
Inst. No.	INSTRUMENT NUMBER
DRCDT	DEED RECORDS, DALLAS COUNTY, TEXAS
MRCDT	MAR RECORDS, DALLAS COUNTY, TEXAS
OPRCDT	OFFICIAL PUBLIC RECORDS, DALLAS COUNTY, TEXAS